

Design Advantages

1. Fabricated discharge head for 10" or larger sizes. Suitable for temperaturer liquid pumping.
 2. Seamless flanged ends column pipe and flanges bowl construction incorporating registered fits for ease of assembly during assembly.
 3. Alloy construction with external tube flush of critical wear areas available for abrasive services.
 4. Build-in alignment and simple piping for less costly installation and ease of maintenance reduced downtime.
 5. 416SS shafting. Keyed lineshaft coupling available in all size for ease of maintenance.
- The lineshaft can be protected by water flushing the enclosing tube bearing on corrosive/abrasive services.
6. Various bearing material available.
 7. Renewable shaft sleeve or hard facing of shaft available for long life.
 8. Dual wear rings for impellers and bowls.
- Hard facing wear surfaces available for longer life. Wear rings can be flushed when solids are present in pumpage.

Specification range

- Capacities to 4000m³/h (18,000GPM)
- Heads to 380m (1250ft)
- Temperatures to 200°C (388°F)

Services

- Cooling Water
- Seawater and Raw Water Intake
- Industrial Process Pumps
- Utility Circulating Water
- Condenser Circulating Water Pumps
- Ash Sluice
- Fire-fighting

VTC, VTG Industrial Turbine Pumps

VTC Selection Charts

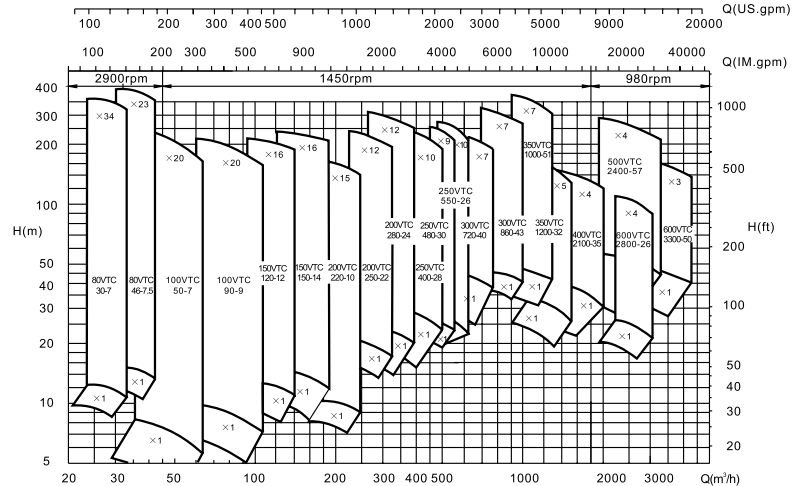
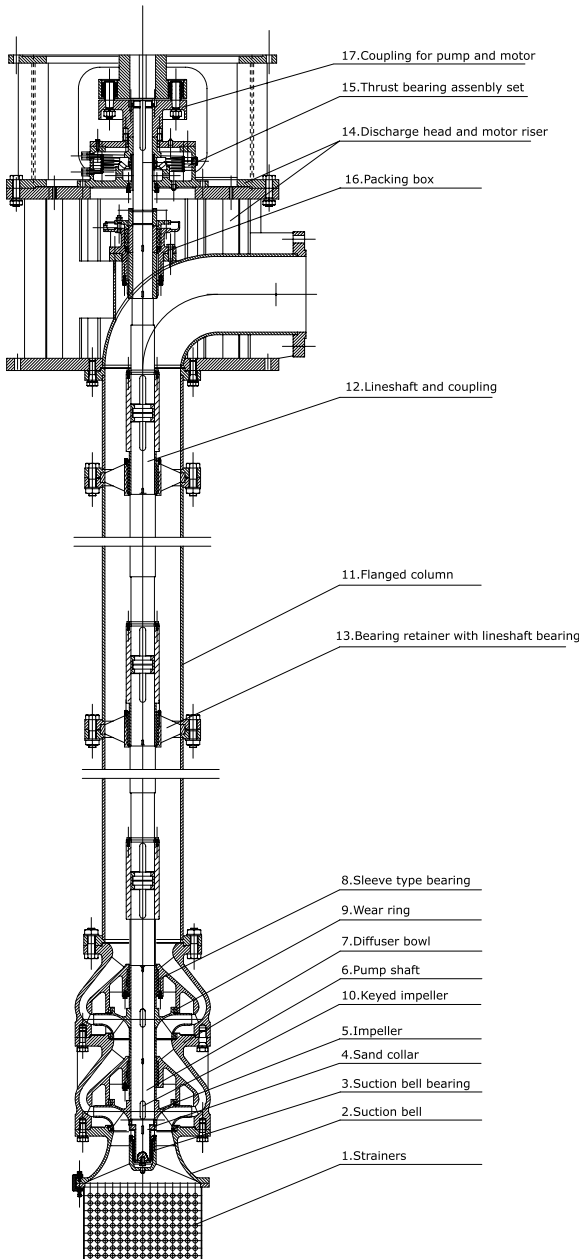

VTC Pump Bowl Assembly Dimensions

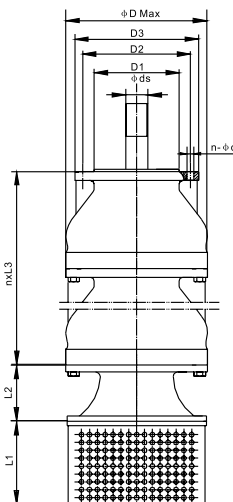

Model	D Max	L1	L2	L3	Max n	D1	D2	D3	φd	n-φd
80VTC30-7	133	200	80	90	34	132	160	200	22	8-φ18
80VTC46-7.5	144	200	80	100	23	132	160	200	22	8-φ18
100VTC50-7	245	260	80	185	20	130	168	200	20/30	8-φ13.5
100VTC90-9	245	260	80	205	20	130	168	200	20/30	8-φ13.5
150VTC120-12	323	280	110	230	16	245	285	323	30/40	8-φ18
150VTC150-14	323	280	110	230	16	245	285	323	30/40	8-φ18
200VTC220-10	285	300	100	245	15	230	256	285	30/40	8-φ18
200VTC250-22	420	300	120	300	12	330	380	420	40/50/60	12-φ22
200VTC280-24	420	300	120	300	12	330	380	420	40/50/60	12-φ22
250VTC550-26	430	320	120	365	10	350	395	430	50/60/70	12-φ22
250VTC400-28	477	320	150	330	10	375	425	477	50/60/70	12-φ22
250VTC480-30	477	320	150	330	9	375	425	477	50/60/70	12-φ22
300VTC720-40	570	320	220	390	7	340	385	425	60/70/80	12-φ22
300VTC860-43	570	320	220	390	7	340	385	425	70/80/90	12-φ22
350VTC1200-32	525	320	230	600	5	420	480	525	60/70/80	16-φ22
350VTC1000-51	630	320	250	430	7	395	480	550	70/90/110	16-φ33
400VTC2100-35	550	320	230	600	5	440	500	550	70/90/100	16-φ22
500VTC2400-57	955	320	390	675	4	605	740	850	90/100/120	16-φ30
600VTC2800-26	720	320	350	940	4	620	740	850	80/100/110	16-φ30
600VTC3300-50	880	320	280	760	3	650	725	780	90/110/130	16-φ30