

**SWB**

**Stainless steel horizontal single-stage centrifugal pump**



**Definition of model**



**Applications**

Applied to pumping thin, clean, non-flammable and non-explosive liquid containing no solid granules and fibers. Such as:

- Domestic water supply
- Irrigation
- Water transfer
- Washing systems
- Boosting

**Features**

- Made of high quality anti-corrosive materials, compact design, robustness
- TEFC motor, easy and safe to operate.
- Coaxial pump design, float neck ring structure, improved mechanical efficiency and volume efficiency.
- Screwed thread connection, easy and simple to install.
- Simple structure, less parts, easy to maintain and service.

**Technical data**

	SWB6-25	SWB6-18
Max. suction head	7 m	
Liquid temperature	-15°C~+80°C	
Max. ambient temperature	+40°C	
Max.pump casing pressure	0.8 MPa	
Inlet size	G1.25	
Outlet size	G1	

**Material table**

Parts	Casing	Impeller	Shaft	Rotating	Stationary	Neckring	O-Ring	Motor house
Materials	SS 304	SS 304	SS 304	Ceramic	Carbon	PTFE	NBR	Aluminum alloy

**Electrical data table**

Model	Power	Voltage/Current			Frequency	Speed	Protection class
		Single-phase	Three-phase				
SWB6-25	1.1kW	220V/6.42A	220V/4.3A	380V/2.48A	50Hz	2900r/min	IP55
SWB6-18	0.75kW	220V/4.45A	220V/2.84A	380V/1.64A			

**Performance table**

Model	Driving motor (kW)	Q(m <sup>3</sup> /h)	H(m)				
			0	3	6	9	12
SWB6-25	1.1	H(m)	29	27.5	25	22	18
SWB6-18	0.75		21.5	20.5	18	16	

Outline and installation dimension (equipped with single-phase motor)

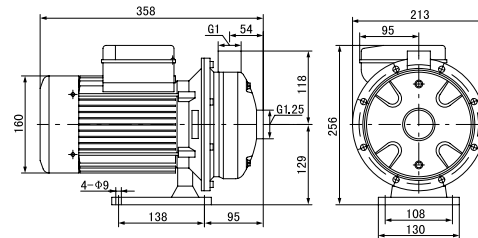

Outline and installation dimension (equipped with three-phase motor)

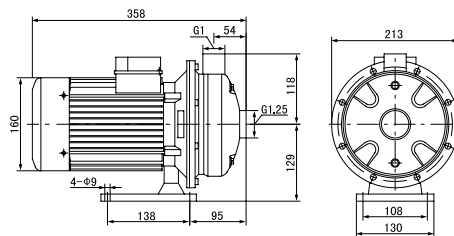

**Performance curve**

