

The new generation of AP6 pumps have been designed to meet market requirements and easy maintenance.



SUBMERSIBLE ELECTRIC PUMP

Application

- Industrial water supply
- Agricultural water supply
- Domestic water supply

Specifications

- Capacity up to 60 m³/h
- Head up to 700 m
- Power up to 45 kW
- 50 Hz , 2 pole
- Standard Voltage 230/400 V
- Max water temperature 30 °C
- Max sand quantity: 185gr/m³
- Direction of rotation: CCW facing delivery
- Max starting per hour: 15

Materials

- Valve body and suction casing in bronze or stainless steel (AISI 304)
- Bronze/rubber bearing bushes
- Splined shaft thoroughly protected (AISI 420)
- Wear rings, interstage diffuser, external jackets, cable guard, suction strainer in stainless steel (AISI 304)
- Radial impeller and diffuser in noryl



IMPELLER AND DIFFUSER ARRANGEMENT

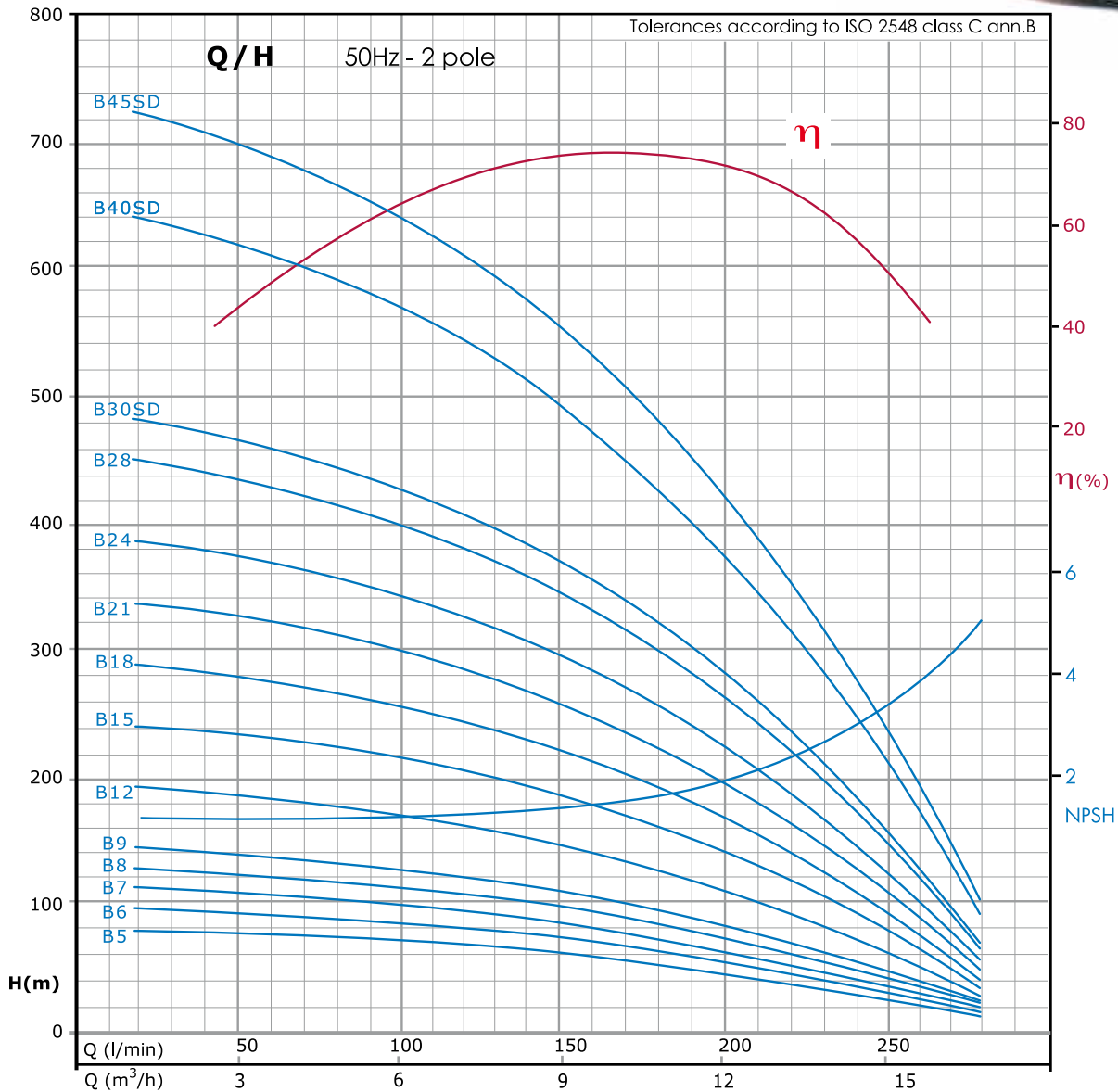

Dimensions, Weights and Electrical Data

1Ph- 220-230V

Type	kW	Length (mm)			Weight (kg)		
		P.L.	M.L.	T.L.	Pump	Motor	Total
AP6B5*	2.2	478	413	891	8.4	13	21.4

Based on using Elsumo motors
*4" motor

3Ph- 380-400-415V

Type	kW	Length (mm)			Weight (kg)		
		P.L.	M.L.	T.L.	Pump	Motor	Total
AP6B5*	2.2	478	393	871	8.4	13.0	21.4
AP6B6*	3	516	544	1060	9.1	19.7	28.8
AP6B7*	3	554	544	1098	9.7	19.7	29.4
AP6B8*	3.7	592	614	1206	10.4	23.0	33.4
AP6B9*	4	630	614	1244	11.0	23.0	34.0
AP6B12*	5.5	744	684	1428	13.0	26.6	39.6
AP6B15	7.5	858	660	1518	15.0	45.5	60.5
AP6B18	9.2	972	685	1657	17.0	49.0	66.0
AP6B21	9.2	1086	685	1771	19.0	49.0	68.0
AP6B24	11	1200	730	1930	20.9	53.0	73.9
AP6B28	13	1404	785	2189	24.8	59.0	83.8
AP6B30SD	15	1603	785	2388	28.4	59.0	87.4
AP6B40SD	18.5	1983	860	2843	35.0	66.5	101.5
AP6B45SD	22	2173	920	3093	38.3	72.5	110.8

Based on using Elsumo motors
*4" motor

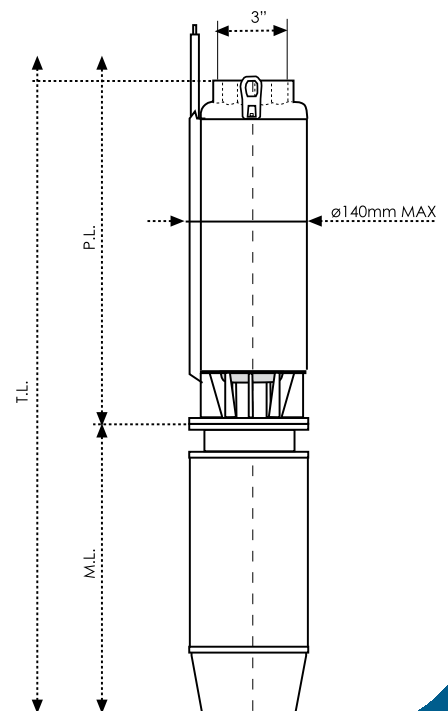

Type AP6D

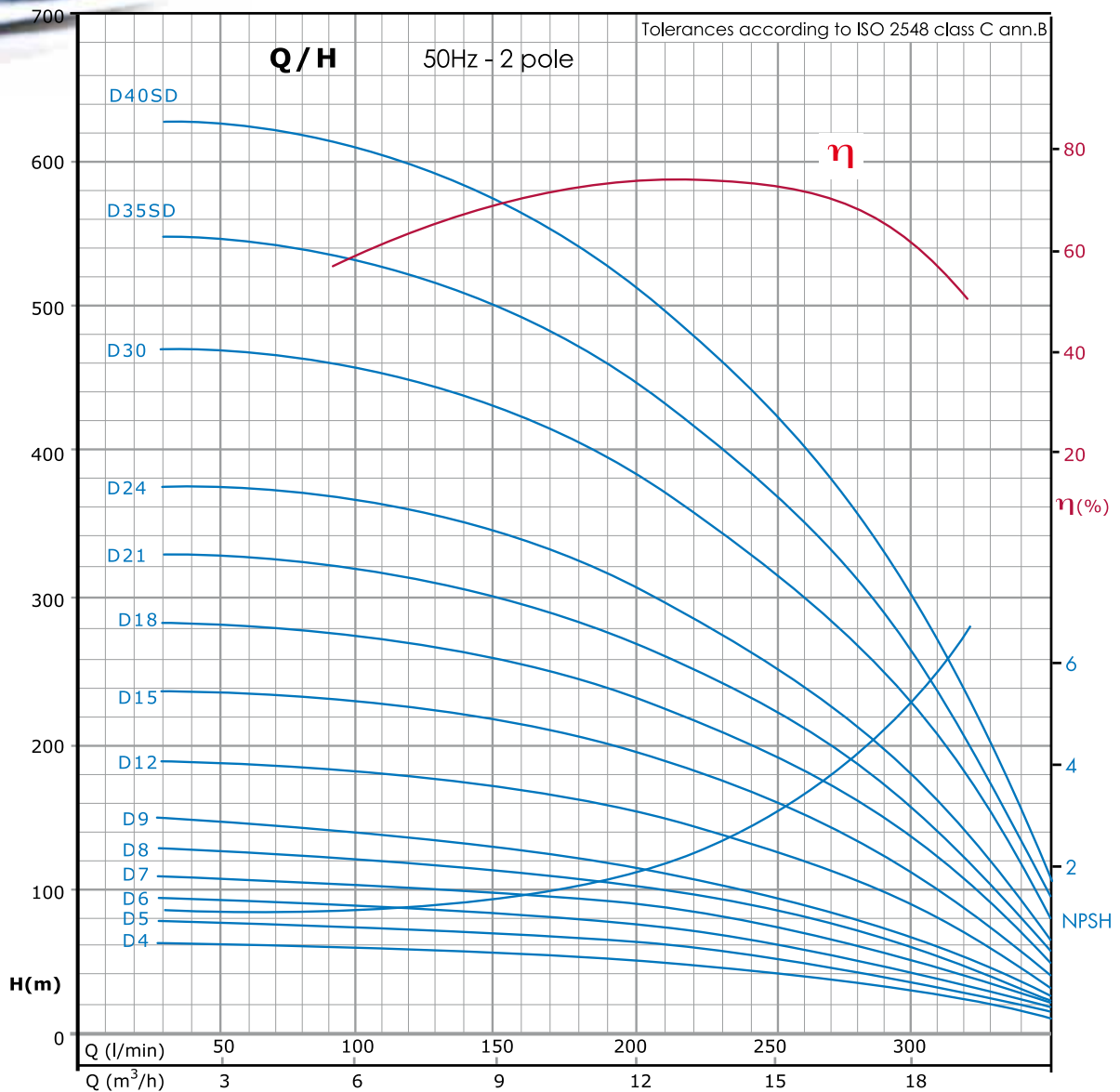

Dimensions, Weights and Electrical Data

1Ph- 220-230V

Type	kW	Length (mm)			Weight (kg)		
		P.L.	M.L.	T.L.	Pump	Motor	Total
AP6D4*	2.2	440	413	853	9.1	13.8	22.9

Based on using Elsumo motors

*4" motor

3Ph- 380-400-415V

Type	kW	Length (mm)			Weight (kg)		
		P.L.	M.L.	T.L.	Pump	Motor	Total
AP6D4*	2.2	440	393	833	9.1	13.0	22.1
AP6D5*	3	478	544	1022	9.8	19.7	29.5
AP6D6*	3.7	516	614	1130	10.4	23.0	33.4
AP6D7*	5.5	554	684	1238	11.0	26.6	37.6
AP6D8*	5.5	592	684	1276	11.7	26.6	38.3
AP6D9*	5.5	630	684	1314	12.4	26.6	39.0
AP6D12	7.5	744	660	1404	14.2	45.5	59.7
AP6D15	9.2	858	685	1543	16.2	49.0	65.2
AP6D18	11	972	730	1702	18.1	53.0	71.1
AP6D21	13	1086	785	1871	22.1	59.0	81.1
AP6D24	15	1200	785	1985	24.0	59.0	83.0
AP6D30	18.5	1480	860	2340	28.9	66.5	95.4
AP6D35SD	22	1793	920	2713	43.0	72.5	115.5
AP6D40SD	26	1983	1050	3033	47.1	85.0	132.1

Based on using Elsumo motors

*4" motor

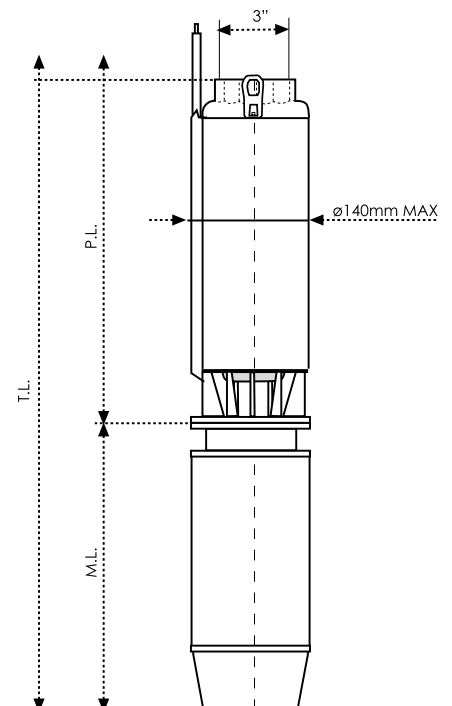

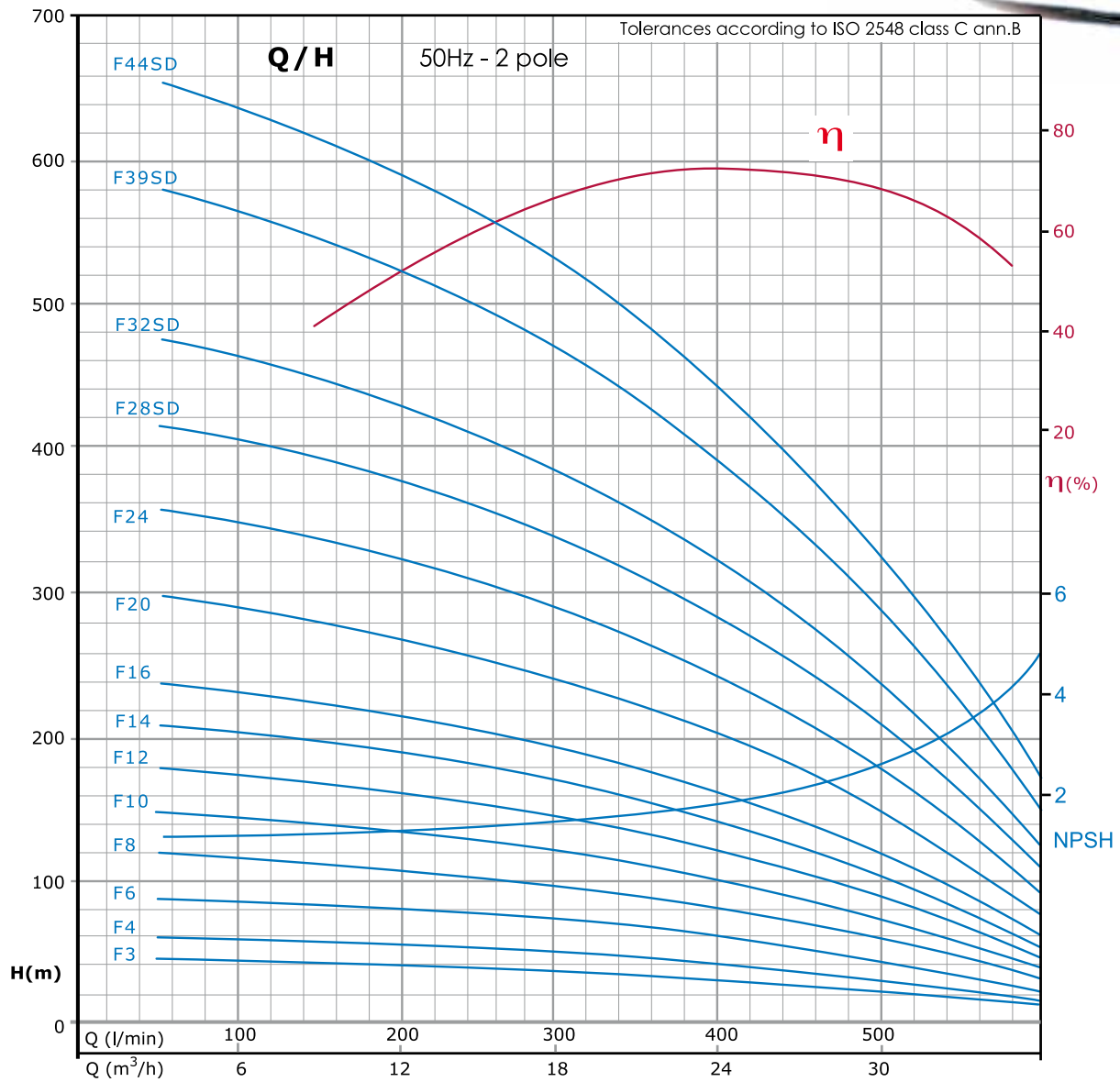
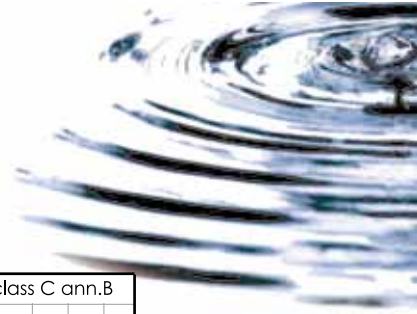

Dimensions, Weights and Electrical Data

3Ph- 380-400-415V

Type	kW	Length (mm)			Weight (kg)		
		P.L.	M.L.	T.L.	Pump	Motor	Total
AP6F3*	3	459	544	1003	9.2	19.7	28.9
AP6F4*	3.7	516	614	1130	10.1	23.0	33.1
AP6F6*	5.5	630	684	1314	11.9	26.6	38.5
AP6F8	7.5	744	660	1404	13.6	45.5	59.1
AP6F10	9.2	858	685	1543	15.5	49.0	64.5
AP6F12	11	972	730	1702	17.3	53.0	70.3
AP6F14	13	1086	785	1871	19.1	59.0	78.1
AP6F16	15	1200	785	1985	20.9	59.0	79.9
AP6F20	18.5	1480	860	2340	27.5	66.5	94.0
AP6F24	22	1708	920	2628	31.3	72.5	103.8
AP6F28SD	26	2059	1050	3109	46.9	85.0	131.9
AP6F32SD	30	2287	1050	3337	51.2	85.0	136.2
AP6F39SD	37	2790	1180	3970	61.0	98.0	159.0
AP6F44SD	45	3075	1243	4318	66.7	143.0	209.7

Based on using Elsumo motors
*4" motor

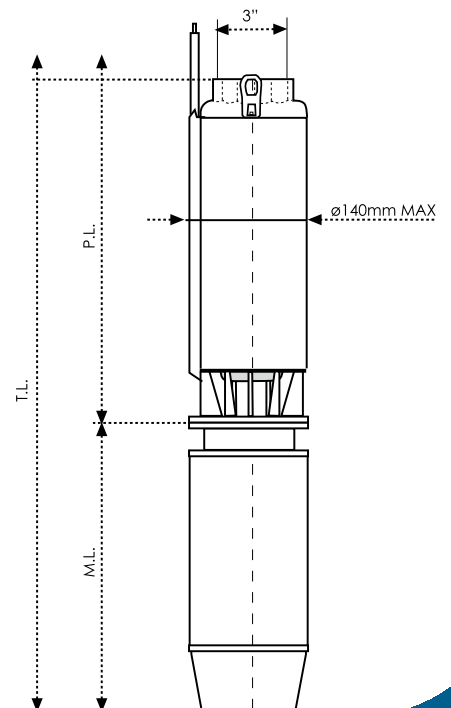

Type AP6H

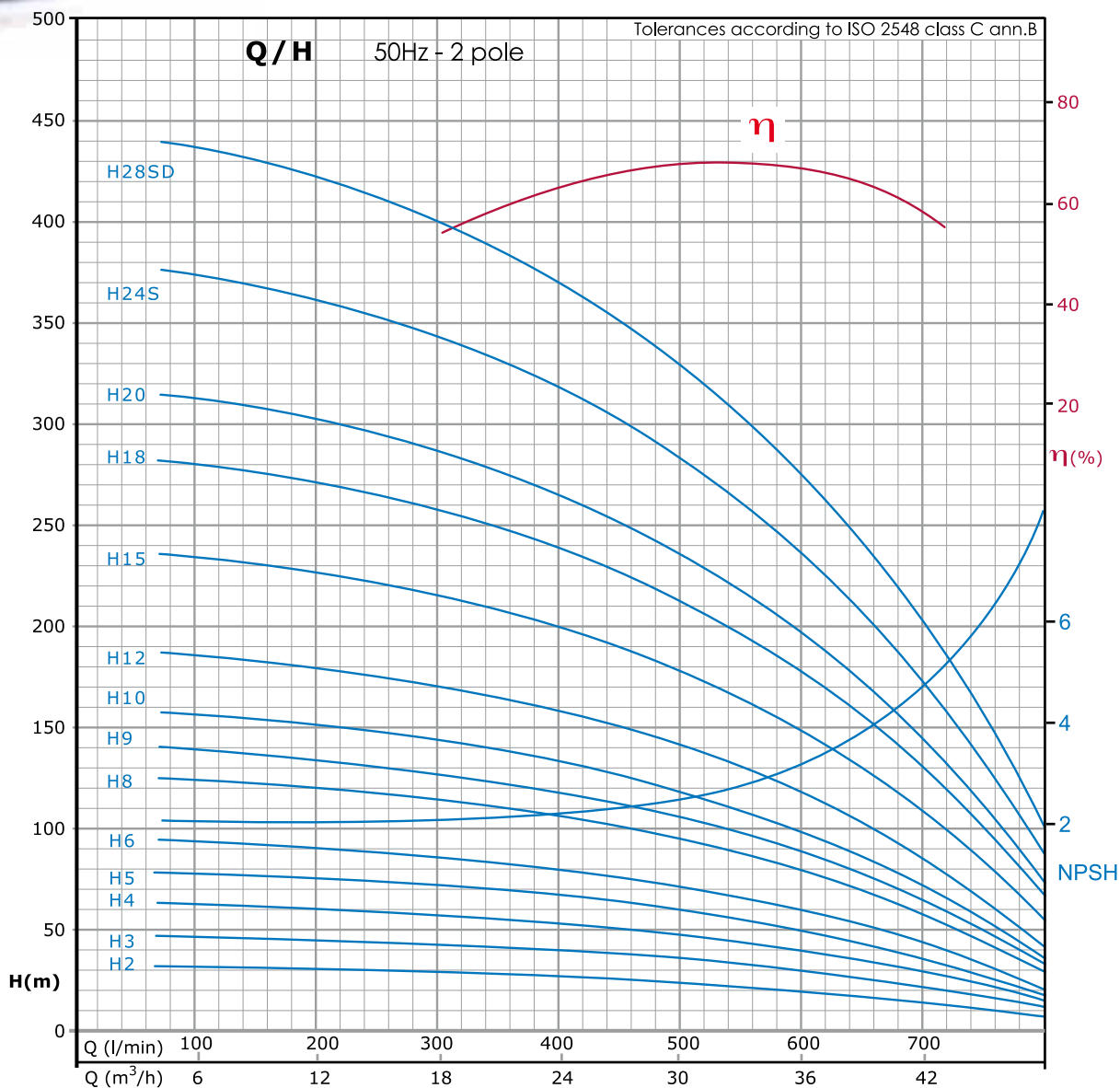

Dimensions, Weights and Electrical Data

3Ph- 380-400-415V

Type	kW	Length (mm)			Weight (kg)		
		P.L.	M.L.	T.L.	Pump	Motor	Total
AP6H2*	3	408	544	952	8.5	19.7	28.2
AP6H3*	4	468	614	1082	9.4	23.0	32.4
AP6H4*	5.5	528	684	1212	10.2	26.6	36.8
AP6H5	7.5	588	660	1248	11.2	45.5	56.7
AP6H6	9.2	648	685	1333	12.1	49.0	61.1
AP6H8	11	768	730	1498	13.9	53.0	66.9
AP6H9	13	828	785	1613	15.0	59.0	74.0
AP6H10	15	888	785	1673	15.8	59.0	74.8
AP6H12	18.5	1008	860	1868	17.7	66.5	84.2
AP6H15	22	1188	920	2108	20.6	72.5	93.1
AP6H18	26	1420	1050	2470	26.4	85.0	111.4
AP6H20	30	1540	1050	2590	28.4	85.0	113.4
AP6H24S	37	1780	1180	2960	37.4	98.0	135.4
AP6H28SD	45	2143	1243	3386	48.3	143.0	191.3

Based on using Elsumo motors
*4" motor

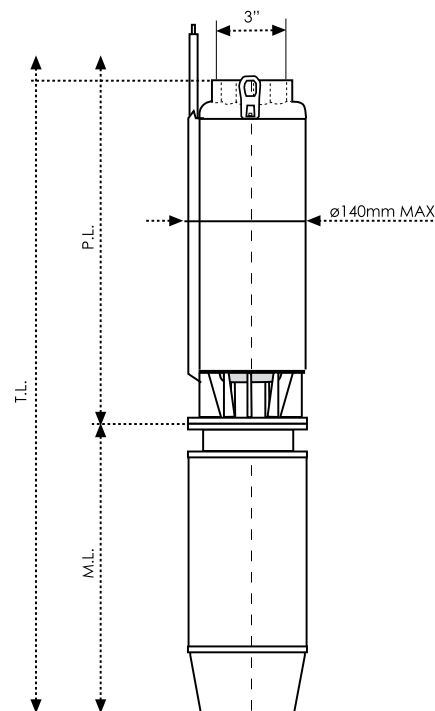

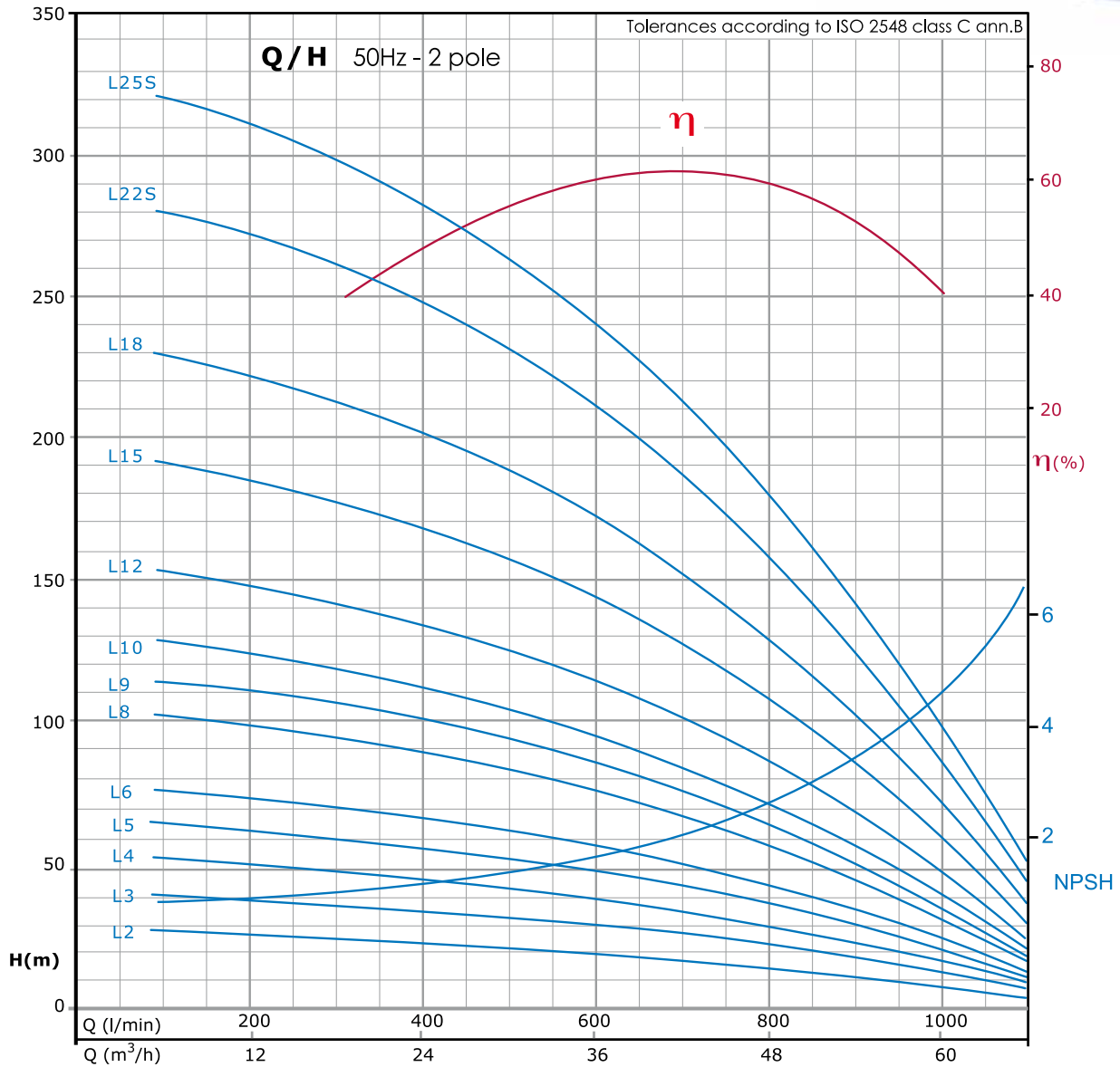

Dimensions, Weights and Electrical Data

3Ph- 380-400-415V

Type	kW	Length (mm)			Weight (kg)		
		P.L.	M.L.	T.L.	Pump	Motor	Total
AP6L2*	3.7	408	614	1022	8.4	23.0	31.4
AP6L3*	5.5	468	684	1152	9.3	26.6	35.9
AP6L4	7.5	528	660	1188	10.1	45.5	55.6
AP6L5	9.2	588	685	1273	11.1	49.0	60.1
AP6L6	11	648	730	1378	12.0	53.0	65.0
AP6L8	13	768	785	1553	13.8	59.0	72.8
AP6L9	15	828	785	1613	14.8	59.0	73.8
AP6L10	18.5	888	860	1748	15.7	66.5	82.2
AP6L12	22	1008	920	1928	17.8	72.5	90.3
AP6L15	26	1188	1050	2238	20.4	85.0	105.4
AP6L18	30	1420	1050	2470	26.2	85.0	111.2
AP6L22S	37	1660	1180	2840	34.8	98.0	132.8
AP6L25S	45	1840	1243	3083	38.2	143.0	181.2

Based on using Elsumo motors
*4" motor

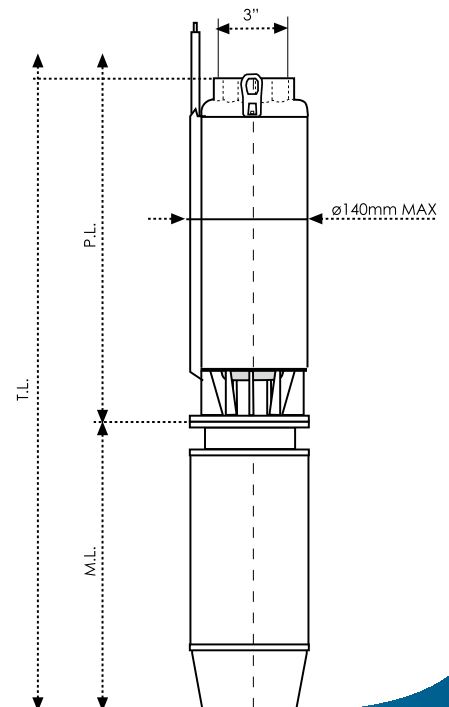

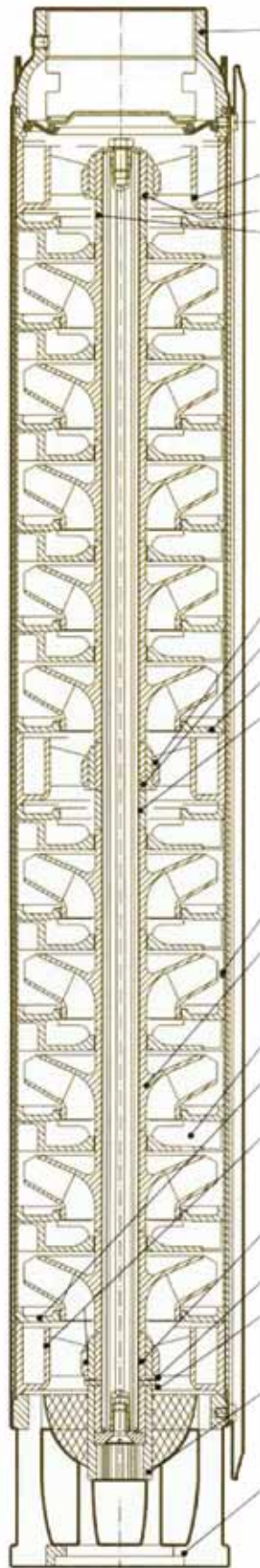

Valve body

Discharge casing
Bearing sleeve
Spacer sleeve

Spare Parts AP6

*Intermediate bearing
*Bearing sleeve
*Disc
*Spacer sleeve

Interstage diffuser casing
Impeller

Diffuser
Disc

Lower support

Bearing sleeve
Counter thrust bearing plate
Counter thrust bearing washer

Coupling

Suction casing